

The 1422

[The Valley at Great Hills Community](#)



PRICE FROM:

\$267,900

 **1,445 Ft²**

 **3 Bedrooms**

 **2 Bathrooms**

 **2 Car Garage**

Some images shown may be from a previously built Stylecraft home of similar design. Actual options, colors, and selections may vary. Contact us for details!

Introducing The 1422 by Stylecraft On Your Lot, a beautifully designed 3 bed, 2 bath home with a split floor plan for optimal privacy. The open common space features a modern kitchen with an island that flows into the dining and living areas, perfect for family gatherings. Enjoy ample storage throughout, including walk-in closets in the secondary bedrooms, a welcoming entry closet, and a spacious pantry. The primary bedroom offers a peaceful retreat, while the secondary bedrooms share a well-appointed bath. Build The 1422 on your own land and customize it to fit your lifestyle. With various exterior designs and an extensive list of included features, Stylecraft On Your Lot ensures your new home is uniquely yours. Welcome to your dream home!

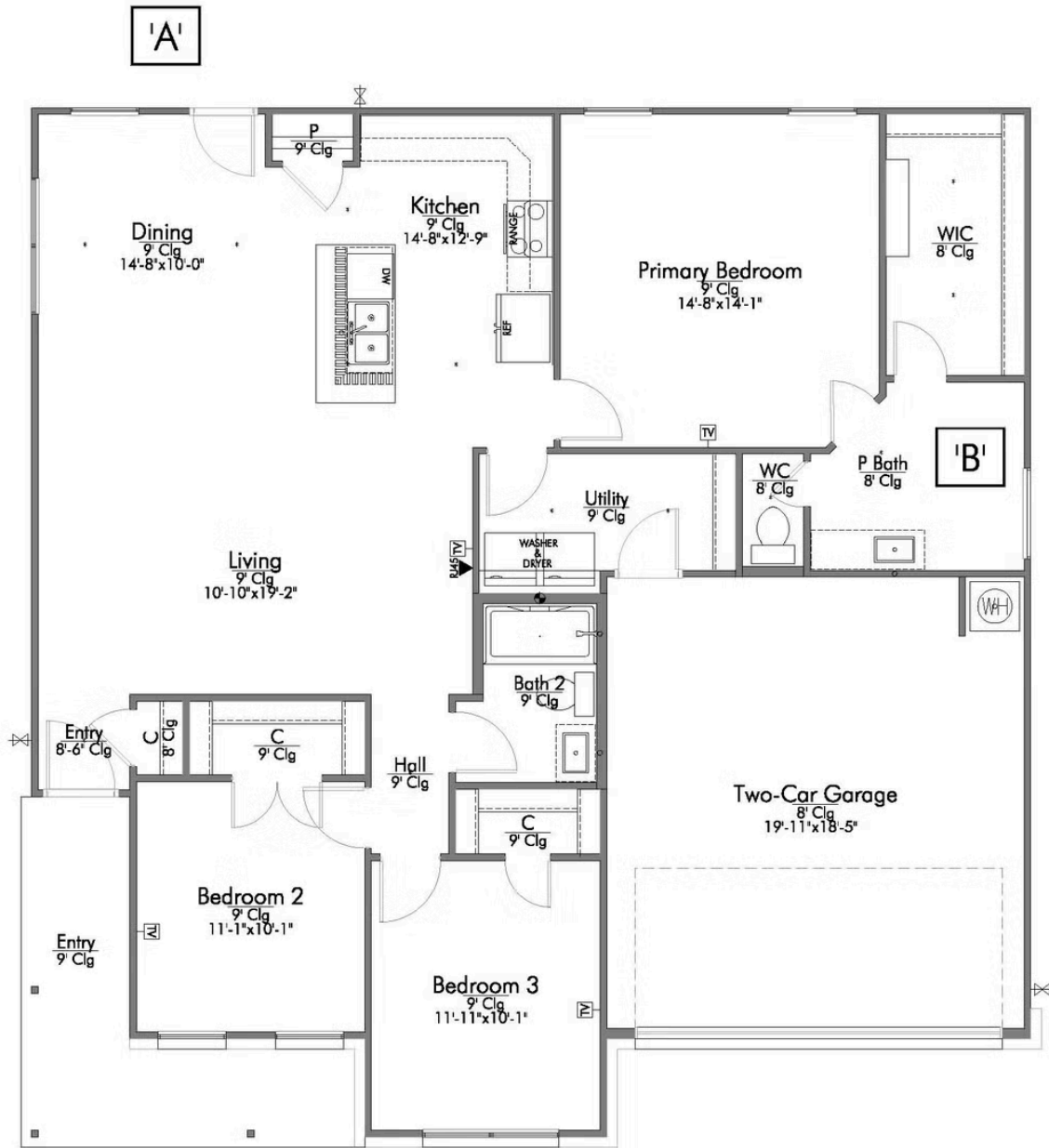

COVERED PORCH

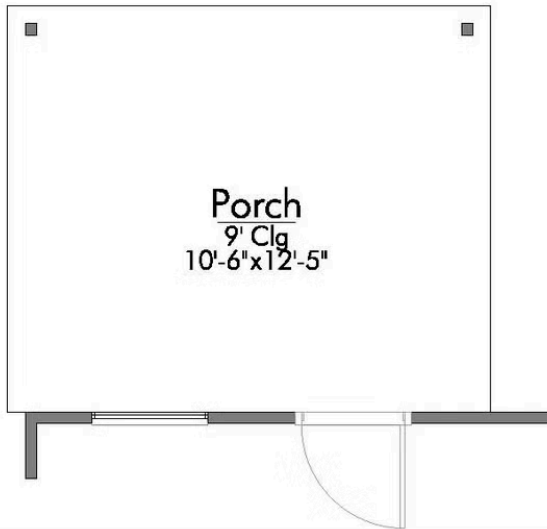

P BATH SECOND SINK

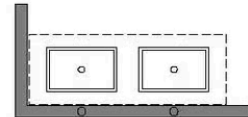

B: TUB/SHOWER

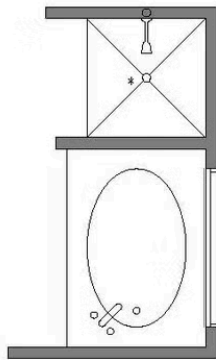

WALK-IN SHOWER

